

DIFA 5Valve Manifold

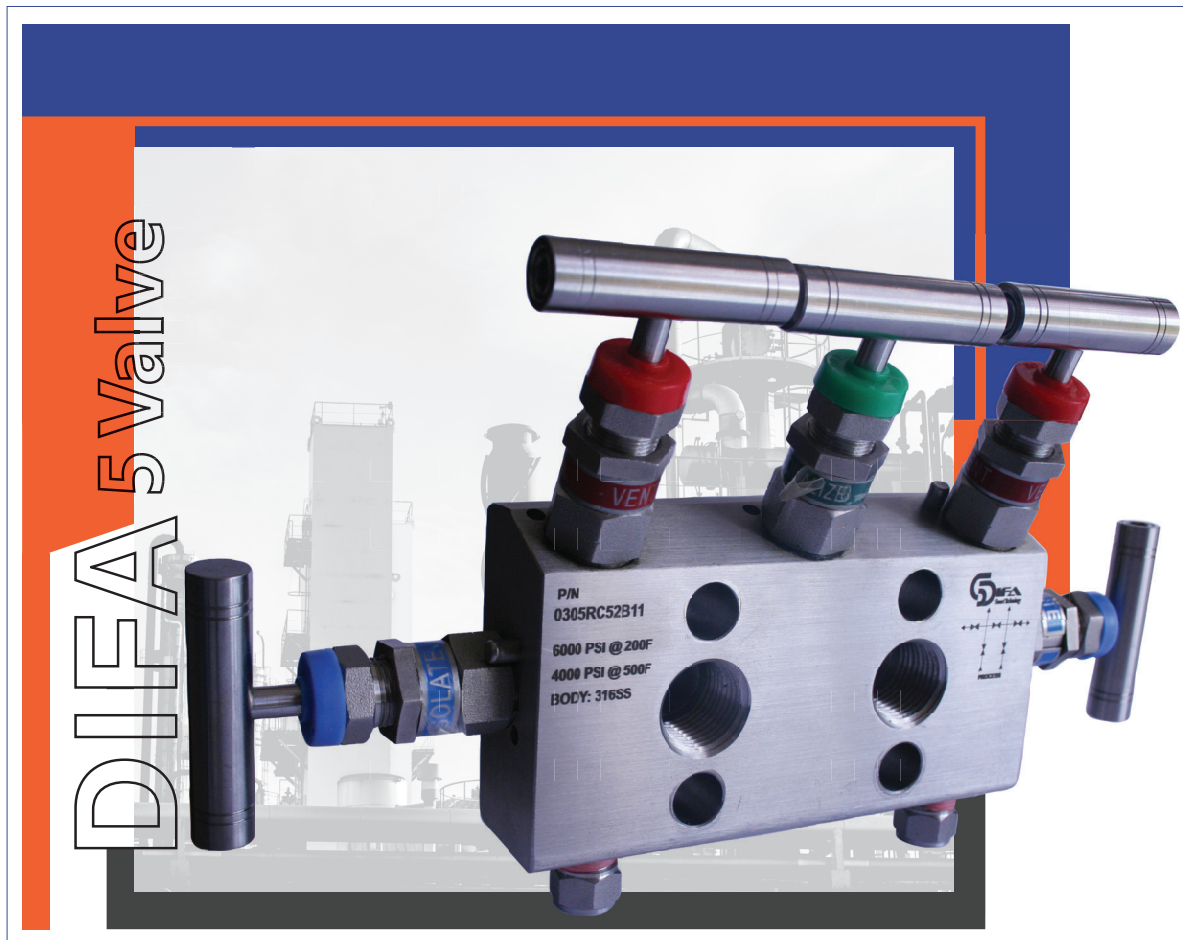

DIFA 5-Valve Coplanar Manifold, Needle Valve, Hard Seat, 6000-10000 psi

"Compact 5-valve manifold with hard-seat needle valve, ensuring accurate isolation and calibration of pressure instruments up to 10,000 psi."

GENERAL

- Shut-off, pressure equalising and vent valves for differential pressure measuring instruments
- For gaseous and liquid aggressive media that are not highly viscous or crystallising, also in aggressive environments
- Process industry: oil and gas, petrochemical, chemical industries, power generation, water and wastewater

FEATURES

- Low-wear design due to non-rotating spindle tip in the bonnet
- Low torque and smooth operation of valve handle even at high pressure
- Standardised centre distances of 37 mm and 54 mm, suitable for various differential pressure gauges and commonly used process transmitters
- Valve seat tested for leak tightness per ISO 5208 leak rate A
- Enhanced working safety due to blow-out proof bonnet design, especially in applications with high pressure loading

5V-01D

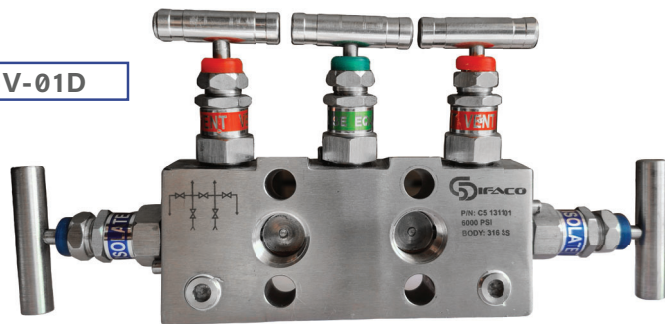

5V-01R



5V-01A
For Rosemount 3051CD



Ordering Information

Model	Inlet	Outlet
5V-01A	½"NPT-FEMALE	Suitable for Rosemount 3051DP transmitter
5V-01D	½"NPT-FEMALE	Suitable for Difa 3351DP transmitter
5V-01C	½"NPT-FEMALE	Customized
5V-01R	½"NPT-FEMALE	Remote type

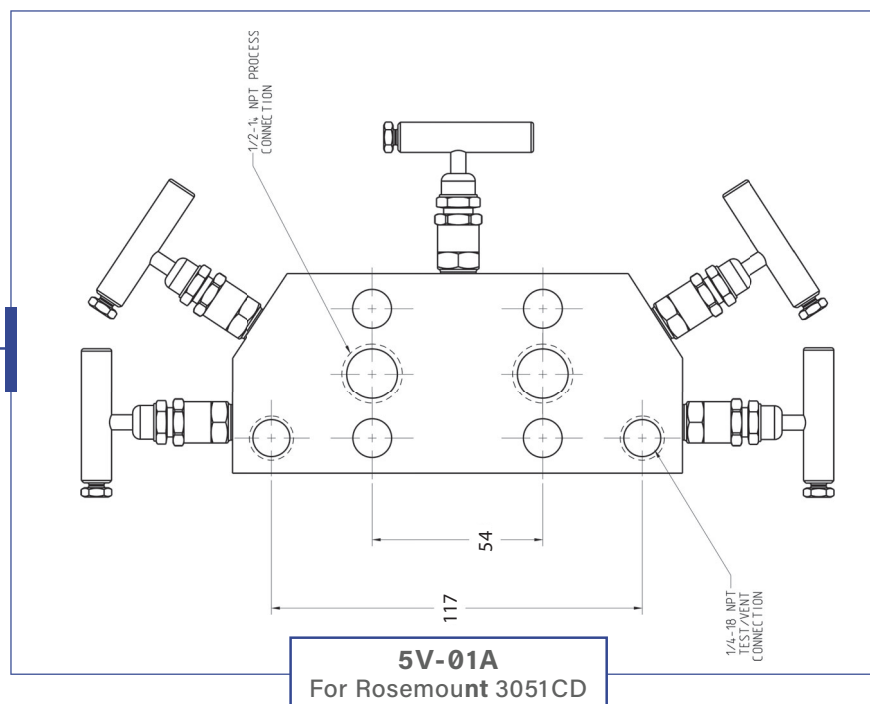
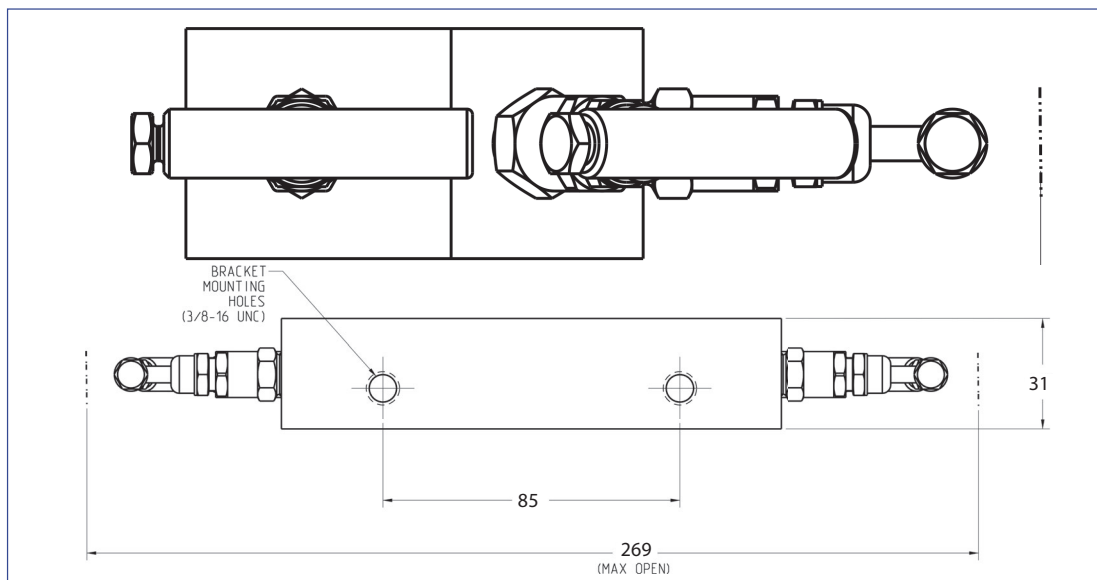

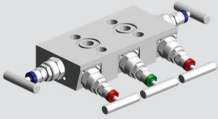
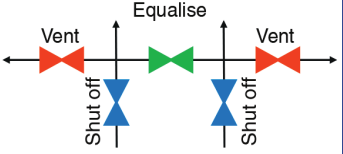
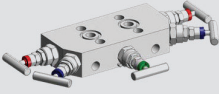
Model	Description		Functional diagram
	5V-01D	<ul style="list-style-type: none"> • 5- valve manifold • Centre distance on instrument side: 54mm[2.12in] • Angled bonnet position • Direct flange mounting 	
	5V-01A	<ul style="list-style-type: none"> • 5- valve manifold • Centre distance on instrument side: 54mm[2.12in] • Radial bonnet position • Integral flange mounting 	